

How to change the sensor block LEDs on the Universal

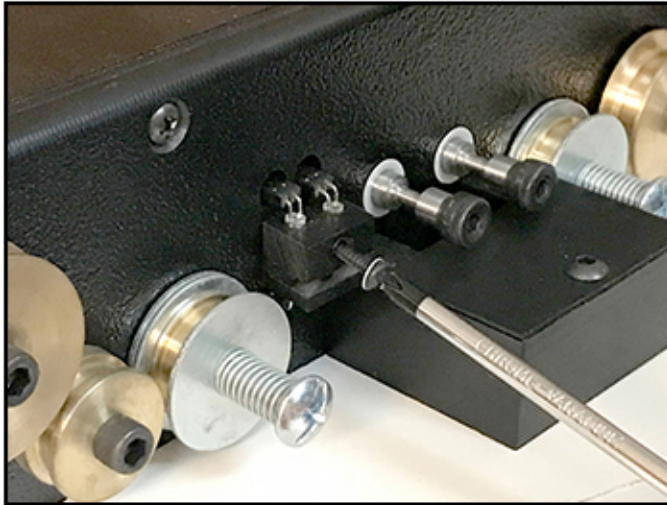

Step 1. Remove Screw

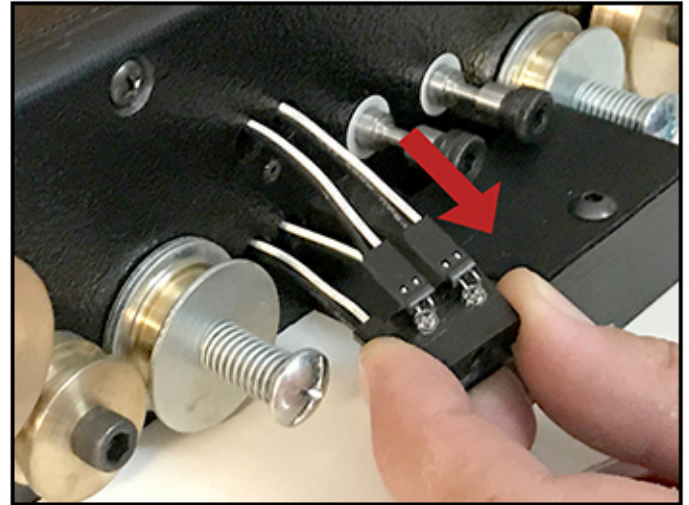

Step 2. Gently pull sensor block & wires

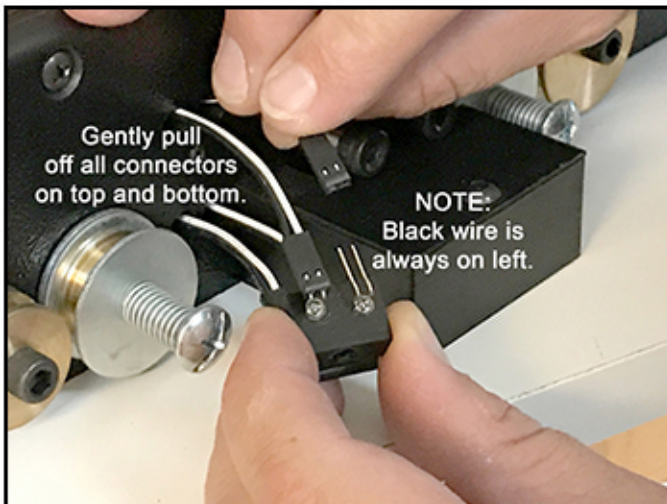

Step 3. Gently pull off all connectors

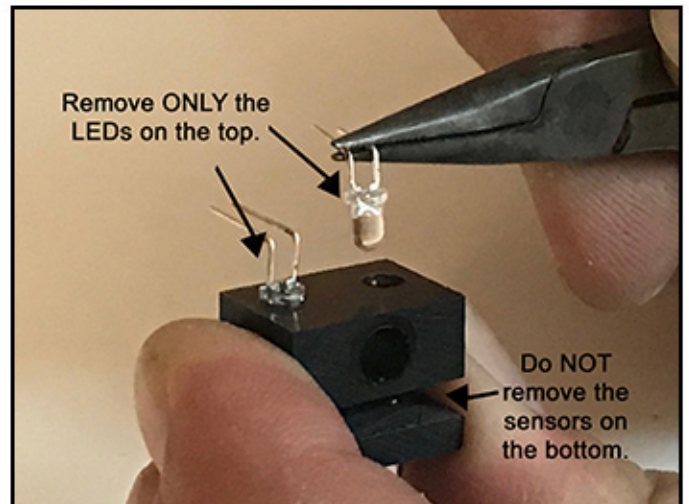

Step 4. Remove top LEDs only.

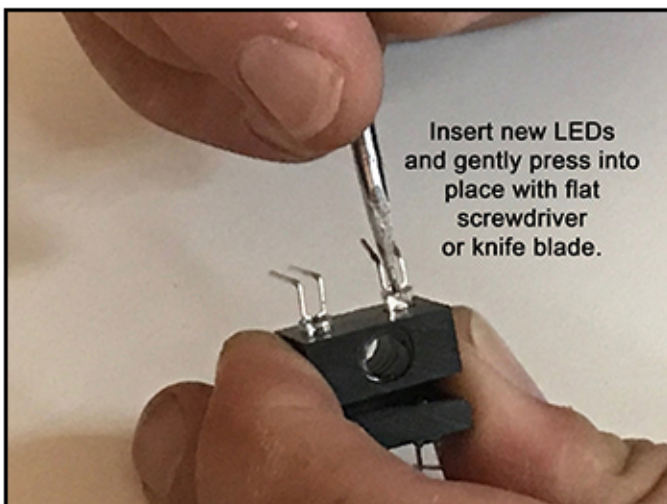

Step 5. Insert new LEDs into block

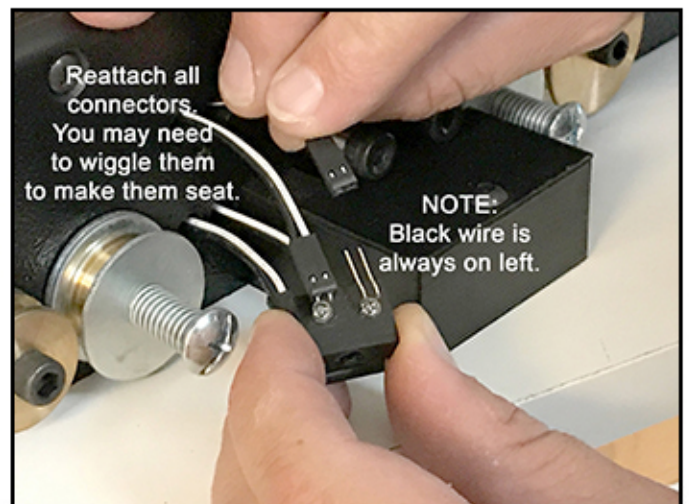

Step 6. Reattach all connectors

How to change the sensor block LEDs on the Universal

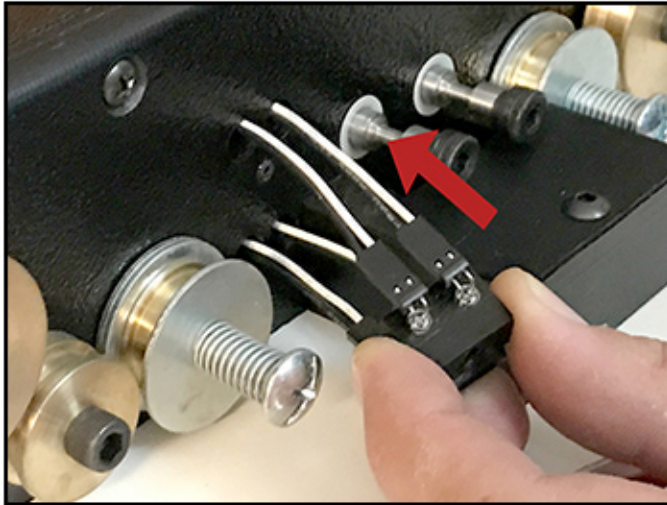

Step 7. Push wires back into box.

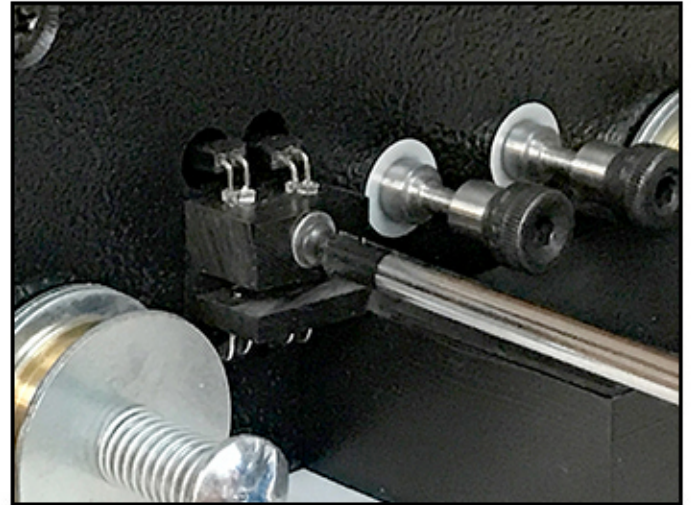

Step 8. Gently tighten screw

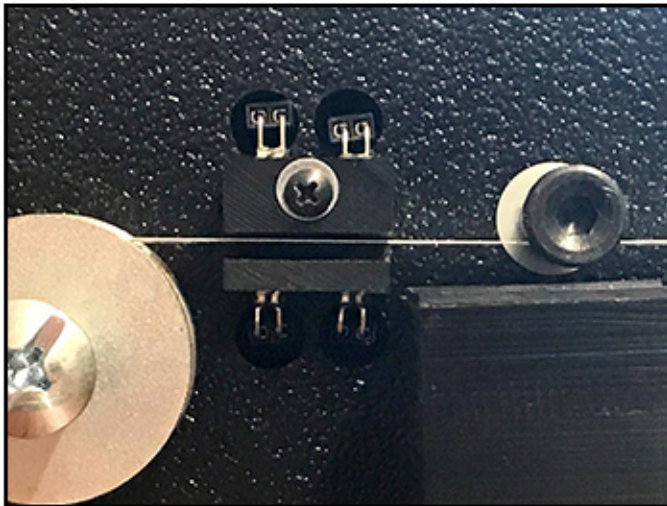

Step 9. Align sensor with film

You are finished!

NOTE: It is important that the film runs very near the top of the sensor slot without touching. You may need to loosen the screw and adjust several times to get it aligned correctly.